

UNITED STATES DEPARTMENT OF THE INTERIOR
 NATIONAL PARK SERVICE
 NATIONAL REGISTER OF HISTORIC PLACES
 REGISTRATION FORM

OMB NO. 1024-0018, NPS FORM

RECEIVED
 MAR 27 1991

526

This form is for use in nominating or requesting determinations of eligibility for individual properties or districts. See instructions in Guidelines for Completing National Register Forms (National Register Bulletin 16). Complete each item by marking "x" in the appropriate box or by entering the requested information. If an item does not apply to the property being documented, enter "N/A" for "not applicable." For functions, styles, materials, and areas of significance, enter only the categories and subcategories listed in the instructions. For additional space use continuation sheets. Type all entries.

1. Name of Property

historic name Skinner, Timothy, House
 other names/site number _____

2. Location

street & number 5355 Scenic Avenue | | not for publication
 city, town Mexico | | vicinity
 state New York code NY county Oswego code 075 zip code 13114

3. Classification

Ownership of property	Category	Number of resources within property	
<input checked="" type="checkbox"/> private	<input checked="" type="checkbox"/> building(s)	Contributing	Noncontributing
<input type="checkbox"/> public-local	<input type="checkbox"/> district	<u>1</u>	_____ buildings
<input type="checkbox"/> public-State	<input type="checkbox"/> site	_____	_____ sites
<input type="checkbox"/> public-Federal	<input type="checkbox"/> structure	_____	_____ structures
	<input type="checkbox"/> object	_____	_____ objects
		<u>1</u>	_____ Total

Name of related multiple property listings: Historic & Architectural Resources of the Town of Mexico, Oswego Co.
 Number of contributing resources previously listed in the National Register 0

4. State/Federal Agency Certification

As the designated authority under the National Historic Preservation Act of 1966, as amended, I hereby certify that this nomination request for determination of eligibility meets the documentation standards for registering properties in the National Register of Historic Places and meets the procedural and professional requirements set forth in 36 CFR Part 60. In my opinion, this property meets does not meet the National Register criteria. See continuation sheet.

Julia S. [Signature]
 Signature of certifying official
 Deputy Commissioner for Historic Preservation
 State or Federal agency and bureau

12/28/90
 Date

In my opinion, the property meets does not meet the National Register criteria. See continuation sheet.

Signature of commenting or other official _____

Date _____

State or federal agency and bureau _____

5. National Park Service Certification

I hereby certify that this property is:
 entered in the National Register.
 See continuation sheet.
 determined eligible for the National Register. see continuation sheet.
 determined not eligible for the National Register.

removed from the National Register.
 other, (explain:)

[Signature] 6/20/91
 entered in the National Register

[Signature] Signature of keeper

Date of Action

6. Function or Use

Historic Function

(enter categories from instructions)

Domestic - single dwelling

Current Functions

(enter categories from instructions)

Social - meeting hall

7. Description

Architectural Classification

(enter categories from instructions)

Italianate

Materials(enter categories from instructions)

foundation Stonewalls Brick

roof Metalother

Describe present and historic physical appearance.

The Timothy Skinner House is a large Italianate style brick residence located on a small lot on Scenic Avenue one-half block north of the intersection of Scenic Avenue and Main Street in the village of Mexico, Oswego County. Surrounding buildings include altered nineteenth-century frame residences and non-historic buildings, precluding the inclusion of this property in the nearby Mexico Village Historic District, which is also a component of this multiple property nomination. The Timothy Skinner house is a two and one-half story Italianate style brick residence Built in c. 1869, it is composed of a three-bay main block and a two-story, two-bay recessed wing on the south side that extends four bays to the west. The metal-clad hip roofs have wide overhangs with bracketed cornices and deep friezes. Windows consist of French doors on the first story and two-over-two sash on the second story, all with decorative carved wood lintels and sills. There are large single-paned windows on the east and north elevations of the main block that pierce the frieze. One-story porches extend across the front of the main block and wing, and the rear of the south elevation, all with carved brackets on a wide entablature, turned balusters and attenuated columns. The railings have been removed from the front porch, and the base of the piers replaced with brick. A two-story bay window is located on the south side of the wing with details similar to the porches. The entrance in the main block is a double door with etched glass panels. The secondary entrances are in the wing on the east and south elevations. A shed addition on the rear was added in 1950 to accommodate a kitchen expansion. It is considered non-contributing.

The interior remains remarkably intact despite some changes to the floor plan done by the American Legion. The entrance hall has a handsome spiral staircase with turned balusters and newel post. The fireplace mantels in the front and back parlors display classical lines with Doric pilasters. The elaborate built-up moldings that surround the doors and window openings survive, as do original pieces of hardware.

There are no surviving outbuildings associated with the property.

8. Statement of Significance

Certifying official has considered the significance of this property in relation to other properties: nationally statewide locally

Applicable National Register Criteria A B C D

Criteria Considerations A B C D E F G

Areas of significance	Period of Significance	Significant Dates
<u>Architecture</u>	<u>c. 1865</u>	<u>c. 1865</u>
_____	_____	_____
_____	_____	_____

_____	Cultural Affiliation
_____	_____
_____	_____

Significant Person	Architect/Builder
_____	_____
_____	_____

State significance of property, and justify criteria, criteria considerations, and areas and periods of significance noted above.

The Timothy Skinner House is architecturally significant under National Register criterion C as a sophisticated and virtually unaltered example of an Italianate style residence in the village of Mexico, Oswego County. Built c. 1865 for a local lawyer, the house exhibits the distinguishing features of the Italianate style, such as its asymmetrical composition, shallow hip roof, bracketed cornice, and well-crafted decorative details. Unlike most houses constructed during the late-nineteenth century in the village and town, the house was constructed of brick, illustrating the personal prosperity of its owner. One of a small number of large Italianate style residences in the village and town, the Skinner house recalls the mid-nineteenth century prosperity achieved in Mexico from successful agricultural and industrial production, an economic condition that was able to support a number of related professional occupations. The house was built for Timothy Skinner, a prominent lawyer in Mexico and a descendant of one of the Mexico's first settlers.

Timothy Warner Skinner, son of Avery and Elizabeth Huntington Skinner, settled in Mexico Village in 1853, having been raised in Maple View (Union Square). After attending school, he was admitted to the bar in 1857, and in the same year he joined with Judge Cyrus Whitney in the law and banking firm of Whitney & Skinner.

Skinner practiced law in Mexico for the remainder of his life in addition to taking on other responsibilities. Elected surrogate for three consecutive terms from 1863 through 1882, he also served as village president, a trustee of Mexico Academy, and as an active member of the Masons. It was during this active and prosperous time that Skinner had the fashionable residence on Scenic Avenue constructed.

Timothy's son, Avery W. Skinner, followed the example of public service set by his father and grandfather; he became a teacher and principal of Mexico Academy. By its name, the auditorium in the present-day high school building commemorates his memory.

It is not known whether an architect was involved with the design of the Skinner house; however, little was spared in constructing the handsome Italianate style home. It is distinguished by the elaborately carved brackets, decorated columns, pilasters and balusters, carved wooden lintels and highly embellished bay windows.

The quality of craftsmanship and attention to detail is continued on the interior. The curving staircase, highly embellished windows and door surrounds, and classical mantelpieces distinguish the house from others of a similar style in the community.

[X] See continuation sheet

United States Department of the Interior
National Park Service

NATIONAL REGISTER OF HISTORIC PLACES
CONTINUATION SHEET

SKINNER, TIMOTHY, HOUSE
MEXICO, OSWEGO COUNTY

Section number 8 Page 2

As the agricultural and industrial production of the town of Mexico increased in the nineteenth-century, the village of Mexico grew as the social, cultural, and political center of the town. Homes of lawyers, bankers, clergymen, and merchants were built both on Main Street and on the adjacent streets. The Skinner house exemplifies those few large-scale residences built for Mexico's most prominent citizens in the nineteenth century. A few others of its size and style are included in the Mexico Village Historic District, a component of this multiple property nomination.

The Skinner family sold the property to the American Legion in 1964. While this organization has made some minor changes to accommodate the group's activities, the Skinner house remains remarkably intact; it is one of the best examples of the Italianate style of architecture in the town.

9. Major Bibliographical References

Grip's Historical Souvenir of Mexico. Syracuse: "Grip," c. 1903.

Churchill, John. Landmarks of Oswego County. Syracuse: D. Mason & Co., 1895.

See continuation sheet

Previous documentation on file (NPS):

- preliminary determination of individual listing (36 CFR 67) has been requested
- previously listed in the National Register
- previously determined eligible by the National Register
- designated a National Historic Landmark
- recorded by Historic American Buildings Survey # _____
- recorded by Historic American Engineering Record # _____

Primary location of additional data:

- State historic preservation office
- Other State agency
- Federal agency
- Local government
- University
- Other

Specify repository: _____

10. Geographical Data

Acreage of property Less than one acre.

UTM References

A 118 400300 4812540
 Zone Easting Northing

C
 Zone Easting Northing

B
 Zone Easting Northing

D
 Zone Easting Northing

See continuation sheet

Verbal Boundary Description

The boundary of the Timothy Skinner House is shown as the bold line on the accompanying map.

See continuation sheet

Boundary Justification

The boundary is the legally recorded lot line of the property, which is the historic boundary of the Skinner lot.

See continuation sheet

11. Form Prepared By

name/title Kathleen LaFrank See Continuation Sheet

organization OPRHP date October 5, 1990

street & number Agency Bldg. #1, Emp. St. Pl. telephone (518) 474-0479

city or town Albany state NY zip code 12238

United States Department of the Interior
National Park Service

NATIONAL REGISTER OF HISTORIC PLACES
CONTINUATION SHEET

SKINNER, TIMOTHY, HOUSE
MEXICO, OSWEGO COUNTY

Section number 11 Page 2

Research and documentation prepared by:

Helen Breitbeck
Heritage Foundation of Oswego

Peter Shaver, Consultant

UNITED STATES DEPARTMENT OF THE INTERIOR
NATIONAL PARK SERVICE

NATIONAL REGISTER OF HISTORIC PLACES
EVALUATION/RETURN SHEET

REQUESTED ACTION: NOMINATION

PROPERTY Skinner, Timothy, House
NAME:

MULTIPLE Mexico MPS
NAME:

STATE & COUNTY: NEW YORK, Oswego

DATE RECEIVED: 3/27/91 DATE OF PENDING LIST: 4/12/91
DATE OF 16TH DAY: 4/28/91 DATE OF 45TH DAY: 5/11/91
DATE OF WEEKLY LIST:

REFERENCE NUMBER: 91000526

NOMINATOR: STATE

REASONS FOR REVIEW:

APPEAL: N DATA PROBLEM: N LANDSCAPE: N LESS THAN 50 YEARS: N
OTHER: N PDIL: N PERIOD: N PROGRAM UNAPPROVED: N
REQUEST: N SAMPLE: N SLR DRAFT: N NATIONAL: N

COMMENT WAIVER: N

ACCEPT RETURN REJECT 5/9/91 DATE

ABSTRACT/SUMMARY COMMENTS:

no USGS map

RECOM./CRITERIA _____
REVIEWER _____
DISCIPLINE _____
DATE _____

DOCUMENTATION see attached comments Y/N see attached SLR Y/N

CLASSIFICATION

___count ___resource type

STATE/FEDERAL AGENCY CERTIFICATION

FUNCTION

___historic ___current

DESCRIPTION

___architectural classification
___materials
___descriptive text

SIGNIFICANCE

Period Areas of Significance--Check and justify below

Specific dates Builder/Architect
Statement of Significance (in one paragraph)

- ___summary paragraph
___completeness
___clarity
___applicable criteria
___justification of areas checked
___relating significance to the resource
___context
___relationship of integrity to significance
___justification of exception
___other

BIBLIOGRAPHY

GEOGRAPHICAL DATA

___acreage ___verbal boundary description
___UTMs ___boundary justification

ACCOMPANYING DOCUMENTATION/PRESENTATION

___sketch maps ___USGS maps ___photographs ___presentation

OTHER COMMENTS

Questions concerning this nomination may be directed to

Phone

Signed Date

UNITED STATES DEPARTMENT OF THE INTERIOR
NATIONAL PARK SERVICE

NATIONAL REGISTER OF HISTORIC PLACES
EVALUATION/RETURN SHEET

REQUESTED ACTION: RESUBMISSION

PROPERTY NAME: Skinner, Timothy, House

MULTIPLE NAME: Mexico MPS

STATE & COUNTY: NEW YORK, Oswego

DATE RECEIVED: 6/13/91

DATE OF PENDING LIST:

DATE OF 16TH DAY:

DATE OF 45TH DAY:

7/28/91

DATE OF WEEKLY LIST:

REFERENCE NUMBER: 91000526

NOMINATOR: STATE

DETAILED EVALUATION: N

ACCEPT RETURN REJECT 6/20/91 DATE

Entered in the
National Register

ABSTRACT/SUMMARY COMMENTS:

RECOM./CRITERIA _____
REVIEWER _____
DISCIPLINE _____
DATE _____

DOCUMENTATION see attached comments Y/N see attached SLR Y/N

CLASSIFICATION

___count ___resource type

STATE/FEDERAL AGENCY CERTIFICATION

FUNCTION

___historic ___current

DESCRIPTION

___architectural classification
___materials
___descriptive text

SIGNIFICANCE

Period Areas of Significance--Check and justify below

Specific dates Builder/Architect
Statement of Significance (in one paragraph)

- ___summary paragraph
- ___completeness
- ___clarity
- ___applicable criteria
- ___justification of areas checked
- ___relating significance to the resource
- ___context
- ___relationship of integrity to significance
- ___justification of exception
- ___other

BIBLIOGRAPHY

GEOGRAPHICAL DATA

___acreage ___verbal boundary description
___UTMs ___boundary justification

ACCOMPANYING DOCUMENTATION/PRESENTATION

___sketch maps ___USGS maps ___photographs ___presentation

OTHER COMMENTS

Questions concerning this nomination may be directed to

Phone

Signed Date



Timothy Skinner House #1
Mexico MRA

Mexico, Oswego Co. NY

Photo: Heritage Foundation of
Oswego Co. © 1988

Neg: NYSOPRHP
Agency Bldg 1
Empire State Plaza
Albany NY 12238

View: from NE



Timothy Skinner House #2
Mexico MRA

Mexico, Oswego Co, NY

photo: Heritage Foundation of
Oswego, c1988

Neg: NYSOPRITP
Agency Bldg 1
Empire State Plaza
Albany NY 12238

view: from SE

Please refer to the map in the
Multiple Property Cover Sheet
for this property

Multiple Property Cover Sheet Reference Number: 64500455

Mexico Town & Village MRA
Mexoco, Oswego Co. New York
Timothy Skinner House
Site Map

building
not to
scale

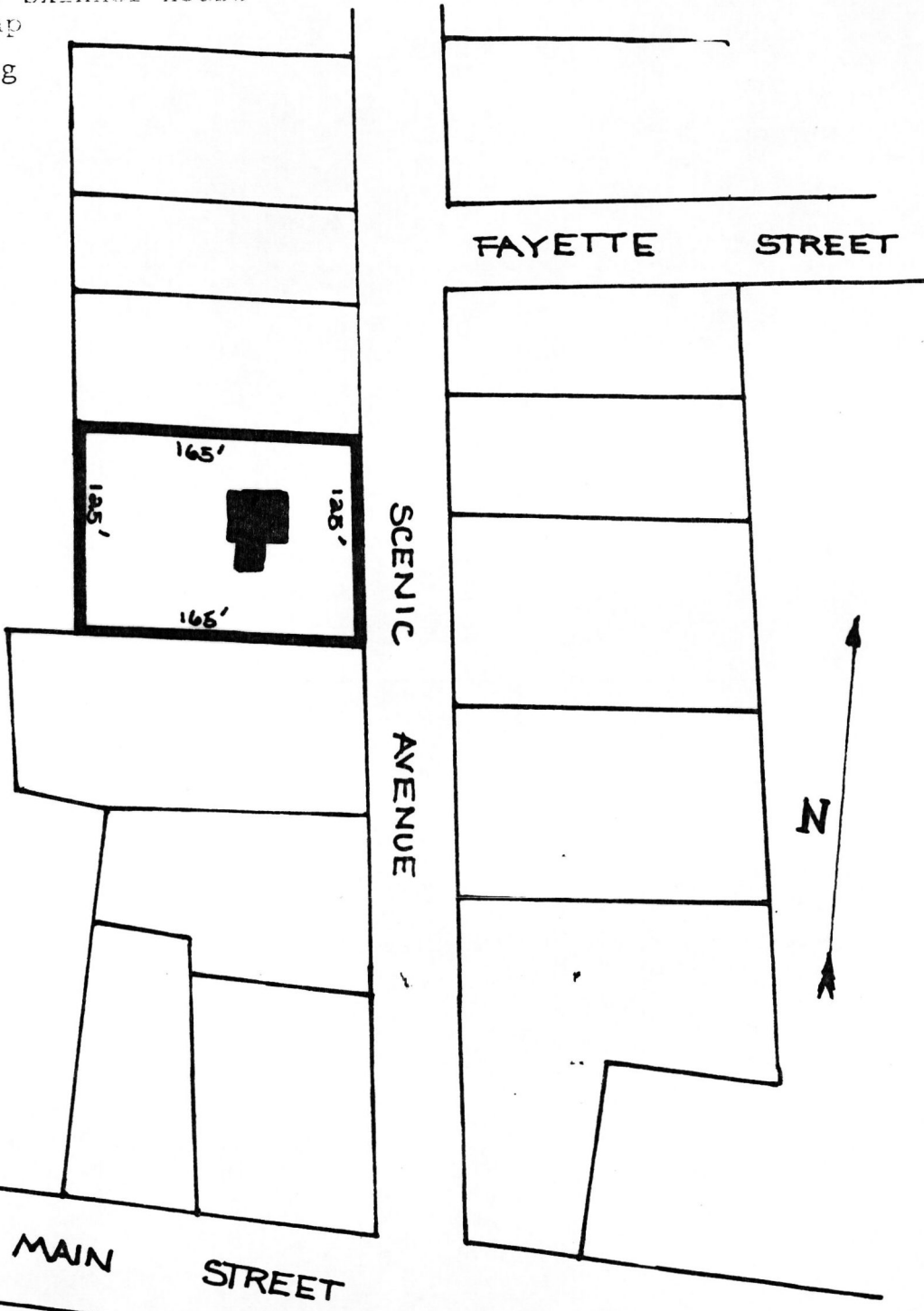

MAIN STREET

FAYETTE STREET

SCENIC AVENUE

N

WASHINGTON ST